



Audra Safe router device

Setup guide

www.audrasecurity.com

Email: info@audrasecurity.com

To set up your new Audra router, follow the steps below using the Audra mobile app

1. Unbox your Audra device

Make sure you have:

- Your Audra router
- Power adapter
- Ethernet cable
- An active internet modem/ONT (provided by you ISP)

2. Download the Audra app

- Open the **Apple App Store** or **Google Play Store** on your smartphone
- Search for '**Audra**'
- Download and install the Audra app
- Open the app to begin setup



3. Power on your Audra router

- Plug your **Audra router** into a power outlet
- Wait until the device powers on
- In the app, tap '**Continue**' when prompted to confirm the device is connected to power

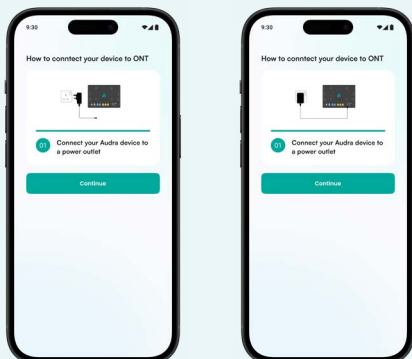

4. Ensure your modem / ONT is powered on

- Make sure your **ONT or modem** is connected to a power outlet
- Confirm it is fully powered on and ready
- Tap '**Continue**' in the app to proceed

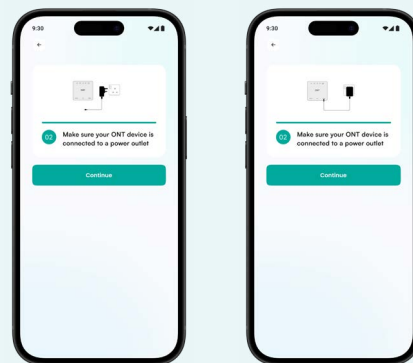

5. Connect Audra to your modem / ONT

- Using the Ethernet cable:
 - Plug one end into the **LAN port** on your modem/ONT
 - Plug the other end into the **2.5G WAN port** on your Audra router
- Tap '**Continue**' in the app



6. Select your Audra device

- The app will scan for nearby devices
- Select your Audra router from the **Available Audra devices** list
- The app will automatically begin downloading configurations

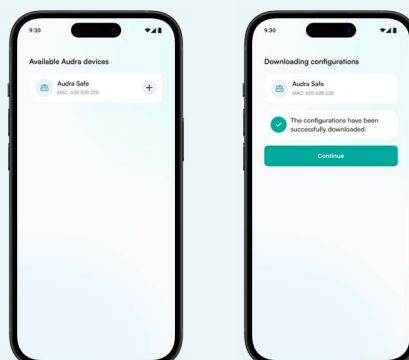

7. Connect your phone to Audra Wi-Fi

- Copy the **Wi-Fi password** shown in the app
- Go to your phone's Wi-Fi settings
- Connect to one of the AudraSafe Wi-Fi networks listed
- Return to the Audra app and tap '**Connect**'

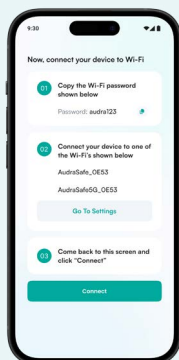

8. Prepare the device

- Keep your phone near the Audra router
- The app will:
 - Connect to the device
 - Update configurations
 - Establish the Wi-Fi network
- This may take a few minutes please be patient

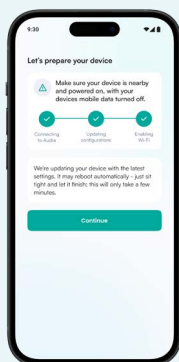

9. Confirm setup completion

- When you see **"You're all set! You can now connect all your devices to the Wi-Fi"**, tap '**Continue**'
- Your Audra router is now online and operational

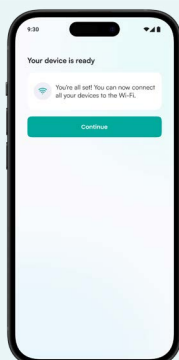

10. Configure Wi-Fi settings

You can customise your network by:

- Editing the **SSID (Wi-Fi name)**
- Changing the **Wi-Fi password**
- Selecting the **security mode (WPA2/WPA3)**
- Turn on Enable WPS and SSID hide

Tap '**Save Configuration**' when finished, or **Skip** to keep the default settings.

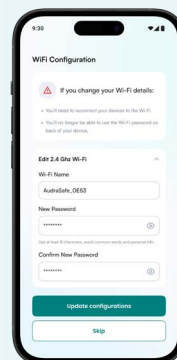

11. Access your network dashboard

- You'll be taken to the Audra home screen
- From here you can:
 - View connected devices
 - Run speed tests
 - Monitor activity and security
 - Manage network settings

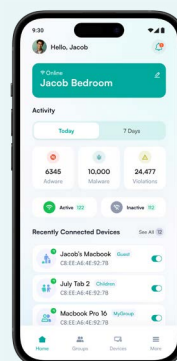



Satisfyingly simple security

Contact us at www.audrasecurity.com/contact

AUDRA SOLUTIONS LIMITED

106 Baker Street, 1st Floor,
London W1U 6TW.

t: +44 333 091 3875
e: info@audrasecurity.com

www.audrasecurity.com